



SHIRE OF PEPPERMINT GROVE

**SHIRE OF PEPPERMINT GROVE**

# ATTACHMENTS

**Late Item**

**Ordinary Council Meeting  
28 March 2017**

# TABLE OF CONTENTS

SUBJECT HEADING	PAGE
9.1.1- 38 Leake Street Peppermint Grove - Attachment # 1.....	3



## **Ordinary Council Meeting**

### **Late Item**

**9.1.1- 38 Leake Street Peppermint Grove -  
Attachment # 1**

115°46'0"E

39149 mN  
21.03 15 17 19 21 23 27 29 31 33.01

STFOI

LEAKE ST

# ITEM 9.1.1 - 38 LEAKE ST

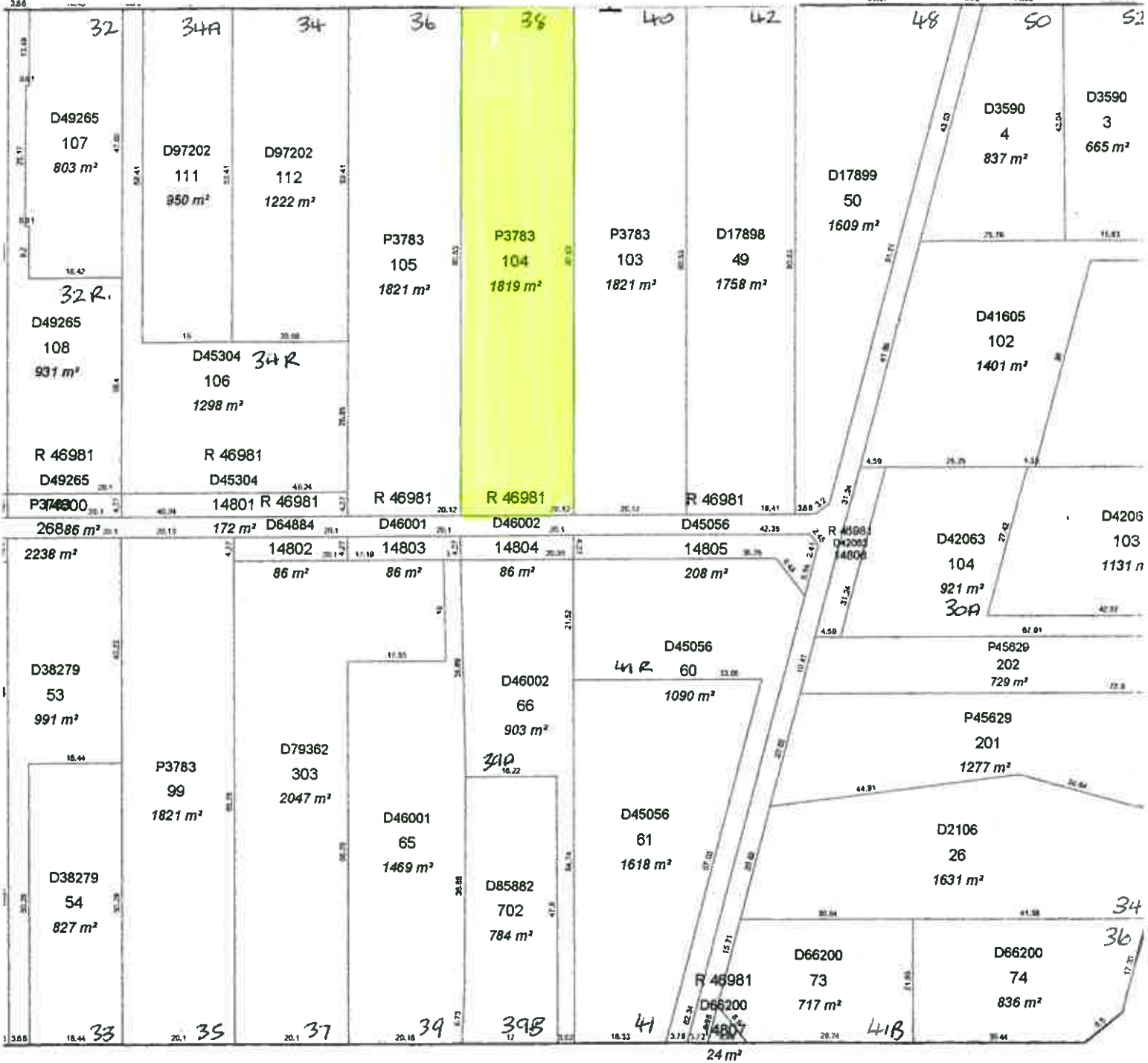

IRVINE ST

## SWAN DISTRICT

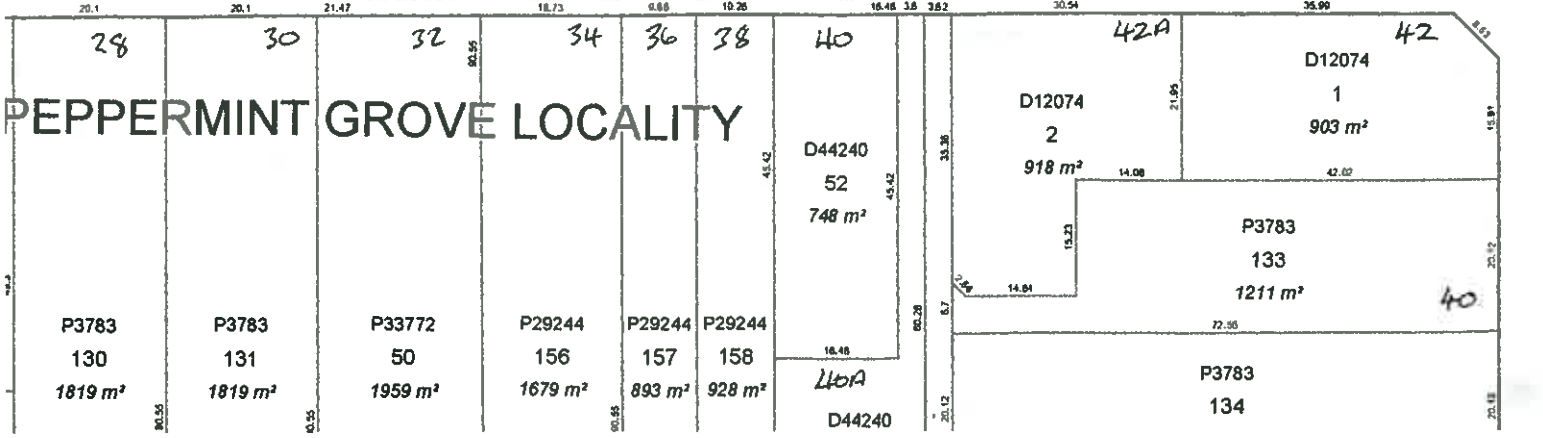

### PEPPERMINT GROVE LOCALITY

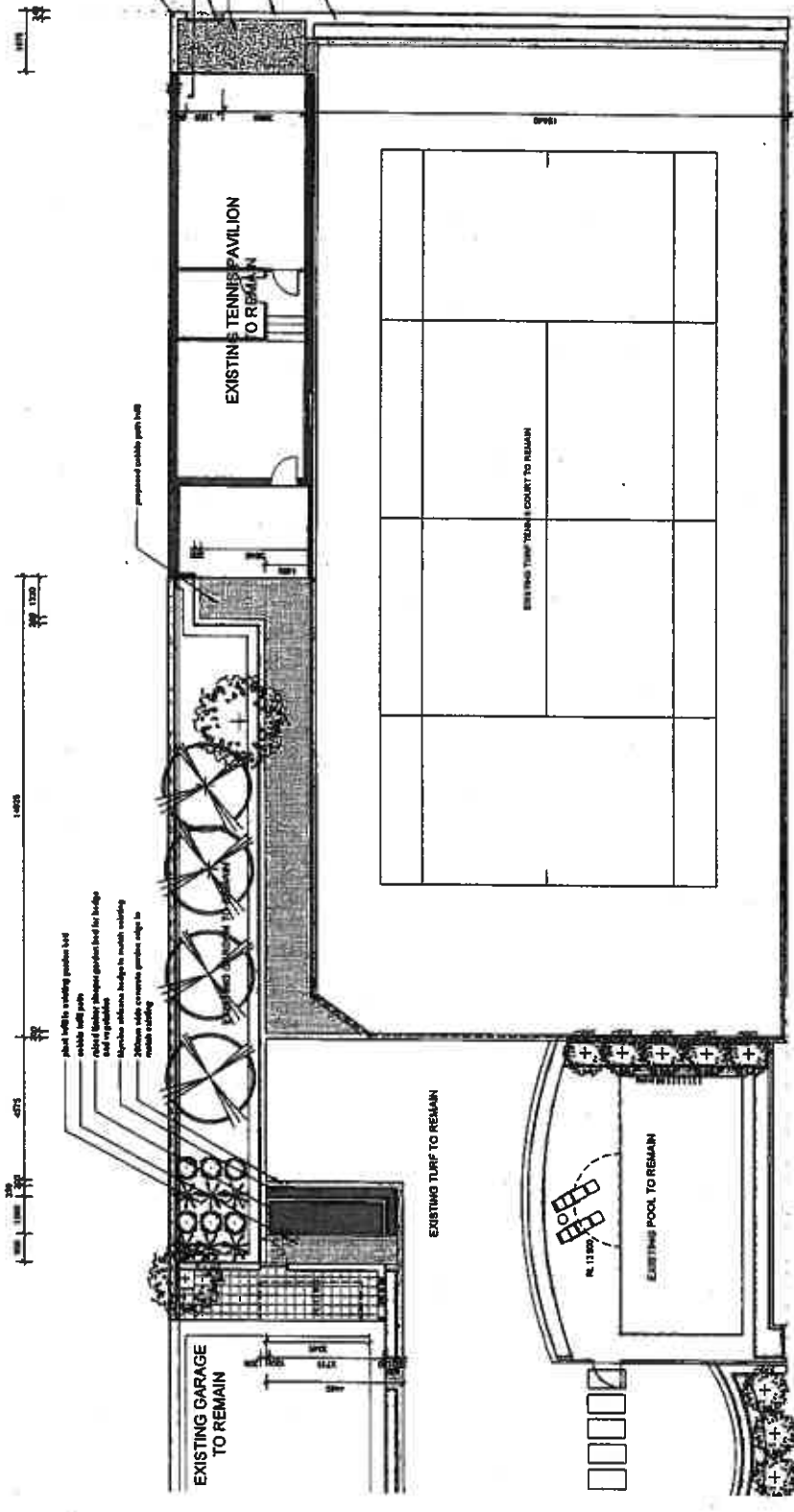
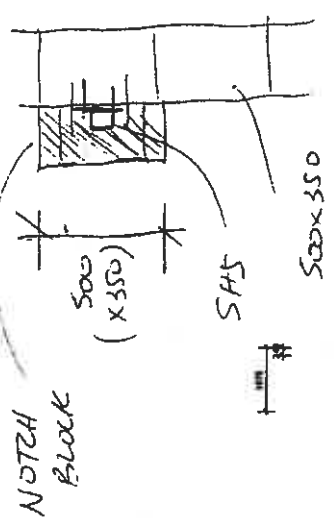

plant within existing garden bed  
 outside wall path  
 plant within temporary garden bed for bridge  
 structure  
 structure additions, bridge to match existing  
 structure  
 bridge edge concrete garden edge to  
 match existing

existing timber fence replaced with  
 aluminium fence, 1.8m high, 1.5m deep  
 existing gate replaced with sliding  
 metal gate  
 existing gate to be replaced with  
 existing fence and gate  
 additional brick work to existing  
 boundary, 1.8m high

EXISTING TURF TO REMAIN

EXISTING POOL TO REMAIN



38 Lesko St, Peppermint Grove

**COLI GARDEN**  
 Landscape Plan

LS 1.1  
 Scale 1:100 @ A2

16-4416  
 COTTLESLOE CONST.

**TAYLOR**

22 NOVEMBER 2018  
 REV 1

Taylor & Taylor are the design team for this project. The design team is responsible for the overall design and construction of the landscape. The design team is not responsible for the structural design of the building or the foundation work. The design team is not responsible for the electrical or plumbing work. The design team is not responsible for the mechanical or HVAC work. The design team is not responsible for the fire or safety work. The design team is not responsible for the environmental or sustainability work. The design team is not responsible for the landscape or site work. The design team is not responsible for the landscape or site work. The design team is not responsible for the landscape or site work.

PERTH BUILDING CERTIFIERS PTY LTD  
**CERTIFIED**  
 23 Dec 2016  
 BUILDING SURVEYOR CONTRACTOR  
 LEVEL 1 (COMPANY) - REGISTRATION No. 106

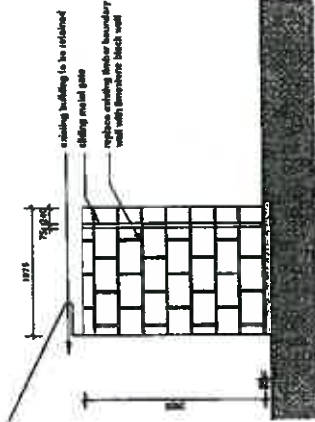

**A LIMESTONE BLOCK WALL - SIDE BOUNDARY**  
 LS 1.1 Scale 1:50

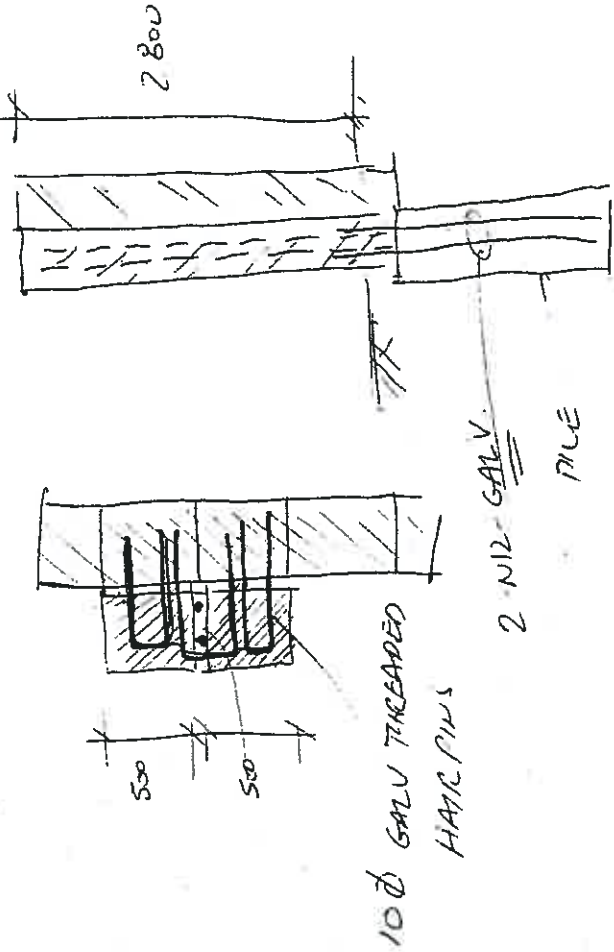

2 N12 GALV

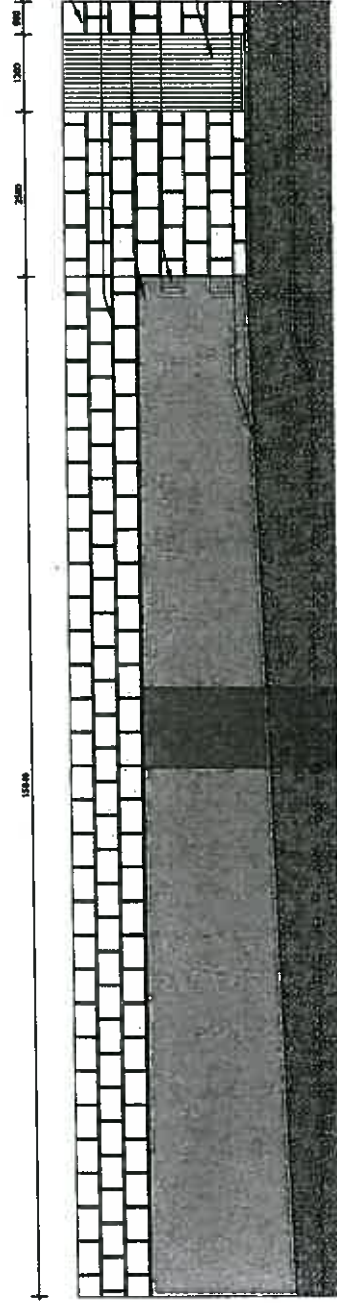

**B LIMESTONE BLOCK BOUNDARY WALL AND GATE - REAR**  
 LS 1.1 Scale 1:50

Shire of Peppermint Grove  
 - 6 FEB 2017  
 RECEIVED

24 Lakes Dr, Peppermint Grove  
**COLI GARDEN**  
 Boundary Wall Detail  
 Scale 1:50

**T A Y L O R**  
 ARCHITECTS  
 P O B O X 271  
 5011 PEPPER MINT GROVE WA 6153  
 REV 1  
 22 NOVEMBER 2015