

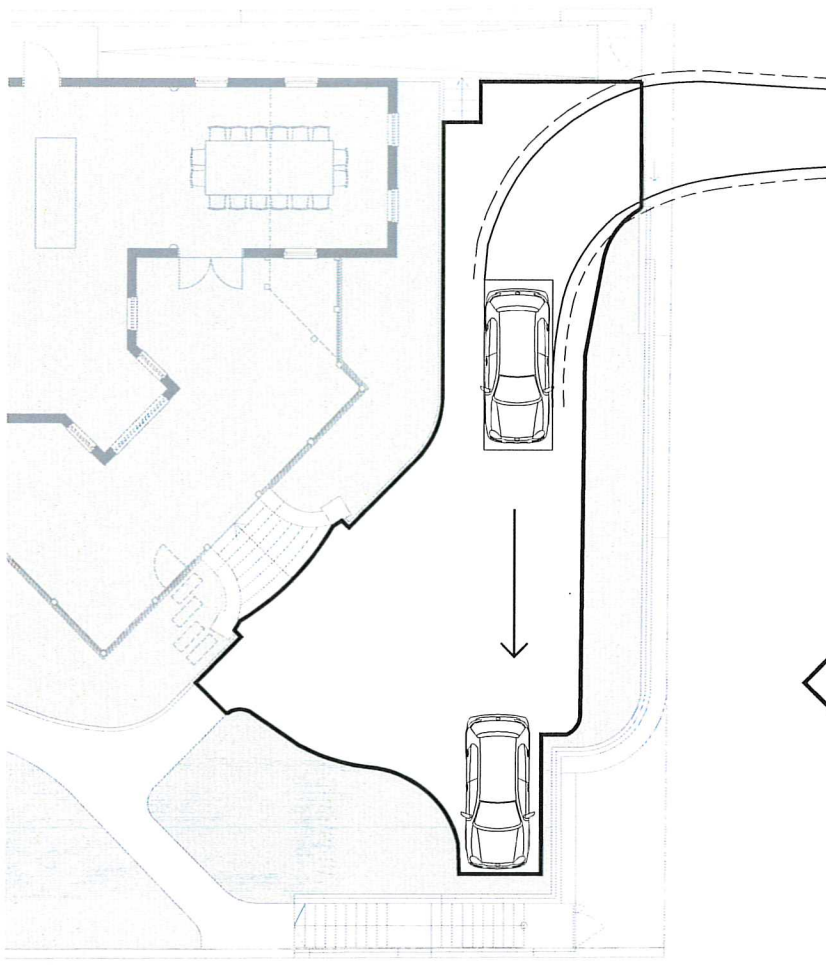

FORECOURT AREA

- RAMP ACCESS ALONG NORTHERN BOUNDARY.
- LIFT & STAIR ACCESS SOUTH SIDE OF BUILDING.



1. SWEEP PATH DIAGRAM
B85 TEMPLATE - 5.8m RADIUS TURN - ENTRY

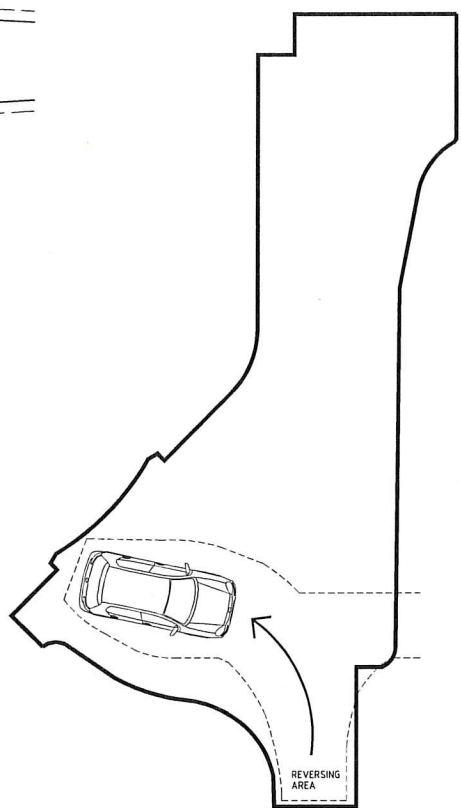

2. REVERSE

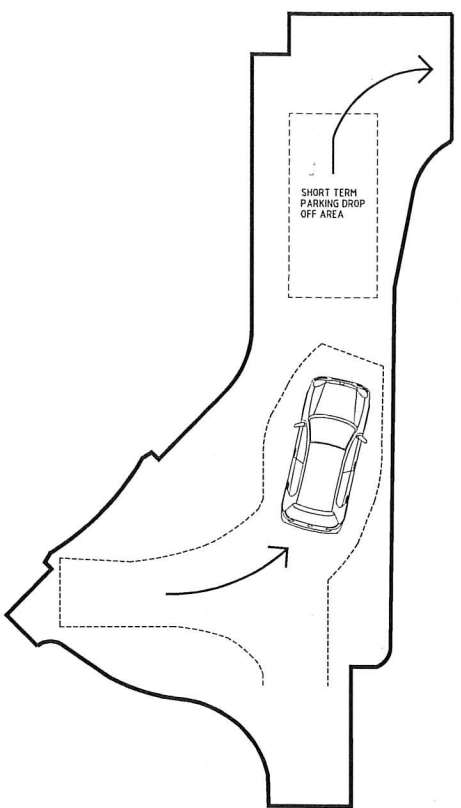

3. FORWARD EXIT

AREA TO BE LANDSCAPED TO PREVENT ADDITIONAL PARKING
 REDUCED PARKING AREA WITH FOOTPATH TO ENTRY STAIRS

DEVELOPMENT APPROVAL

P1	PRELIMINARY - REVISED DEVELOPMENT APPROVAL (MEDIATION)	13-11-2019
REV	DESCRIPTION	DATE
THIS DRAWING SHOULD BE READ IN CONJUNCTION WITH ALL RELEVANT CONTRACTS, SPECIFICATIONS AND DRAWINGS. CONTRACTORS MUST VERIFY ALL DIMENSIONS AT THE JOB BEFORE COMMENCING ANY WORK OR MAKING ANY SHOP DRAWINGS.		

Unit 1/215 Rokeby Road Subiaco
 Western Australia 6008
 Telephone: 08 9381 1666
 Facsimile: 08 9381 1566
 mail@griffithsarchitects.com.au
 ABN 91 277 671 706

Griffiths Architects

LAKESIDE
 12 THE ESPLANADE, PEPPERMINT GROVE
 ADDITIONS AND ALTERATIONS
 FORECOURT TRAFFIC DIAGRAMS

DRAWN	RD	DESIGNED	PG	REDUCTION
CHECKED	PG	PRINCIPAL		0 1m 2m
APPROVED	PG	SIGNATURE		DRAWING No.
SCALE	DATE	NOV 2019		A6.01 ^{P1}
PROJ No.	FILE No.	19116		FILE NO